



# ENERGY, ENVIRONMENTAL PROTECTION, HEALTH AND SAFETY REPORT 2023

KRAIBURG TPE Corporation (USA)

Location: Buford

## PREFACE

KRAIBURG TPE Corporation located in Buford, GA, has been certified in accordance with environmental standard ISO 14001 since 2014. Our Environmental Management System (EMS) is audited annually based on all applicable clauses of the standard. Our corporate policy clearly defines our commitment to environmental protection and preservation of natural resources which are aligned with our sustainability initiatives.

It is our goal as an organization to create a quality product that meets the needs of our customers but also to be mindful of the preservation of the environment, natural resources and protection of our biggest asset, our employees. We have developed performance objectives that focus on areas such as:

- Workplace Safety
- Energy Consumption
- Water Consumption
- Waste Management
- Safety Training

As our corporate policy states, we are a learning organization, and we utilize data to serve as a basis for our continuous improvement.

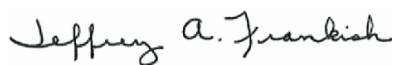

**Jeff Frankish**  
**Managing Director**

## AREA OF APPLICATION

The parameters and assessment limits of the environmental management system at the KRAIBURG TPE site in Buford, GA are defined as follows:

- Facility at Buford: Premises, Production and Office.

## WORKPLACE SAFETY AND HEALTH PROTECTION



At KRAIBURG TPE, safety is a top priority. It is the responsibility of management, as well as every employee, to take all reasonable safety precautions and to protect and ensure the safety and well-being of others. Every employee must understand and follow safety regulations set forth by the company and be proactive in reporting any hazard he/she might observe.

Job Hazard Analysis (JHA) are reviewed for the workplace to ensure all administrative, engineering and PPE controls are in place to minimize the risk of personal injury and that the overall health/safety of every employee is maintained. Support from external safety and environmental consultants are also utilized to ensure compliance to all local, state, and federal regulations.



## **OCCUPATIONAL SAFETY AND HEALTH/ACCIDENTS**



Whenever there is an accident, an extensive investigation is conducted to examine the cause of injury. All information pertaining to accidents is documented and shared with the Safety Committee to explore corrective actions and implementation of safe practices to ensure that there is not a repeat of the accident in the future. The key indicator used to determine our accidental risk is Lost Time Injury Frequency (LTIF) which shows the number of accidents per year that require an employee to be absent from scheduled hours of work.

## **NOISE PROTECTION**



The Production Hall is monitored to follow all regulations to protect our employees against potential effects of occupational noise exposure. We have developed a hearing conservation plan consisting of 4 basic components:

- Exposure Monitoring
- Research and Implementation of Control Measures
- Hearing Protection Selection
- Audiometric Testing

## 2023 KTAM Environmental EH&S PERFORMANCE



### ILLNESS AND INJURY

To measure illness and injury within KTU, the Lost Time Injury Frequency (LTIF) calculation is used. KTU ended 2023 with a LTIF of 2.86 against a target of <8.5. Improvement from 2022 to 2023 was due to additional training on PPE guidelines and JHAs.

Key injuries in 2023:

- Burn, eye irritation, laceration.

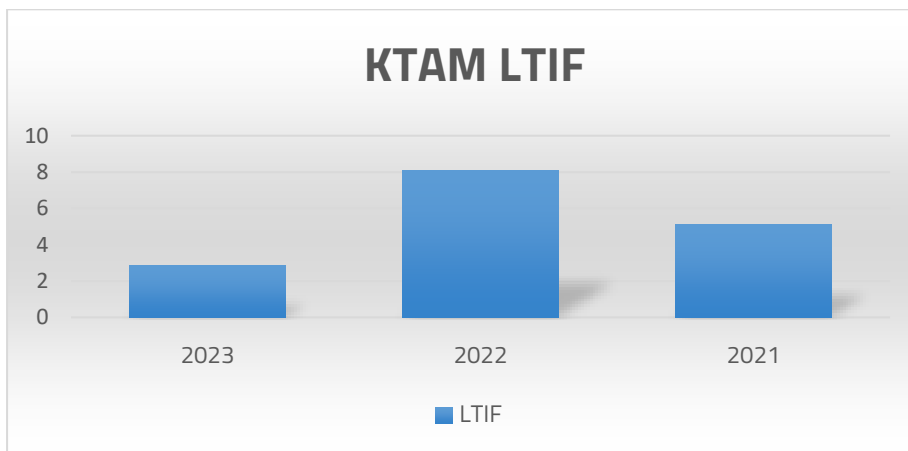



## SAFETY TRAINING COMPLETION PERCENTAGE

KTU ended 2023 with successfully achieving a safety training completion percentage of 99.1% against a target of great than 99%. Online and formal trainings were conducted, to ensure that KTU employees are aware of all safety protocols.



## FIRE PROTECTION / EMERGENCY MANAGEMENT



We have established a contingency and emergency response plan to manage emergency situations that can occur within the facility. Our First Responder team is trained in handling emergency situations such as CPR, AED, First Aid, and fire extinguishing. In 2023, KTU added additional First Responders to ensure that all shifts were adequately staffed. Quarterly

evacuation drills were conducted to ensure that the evacuation procedure is understood and is effective.

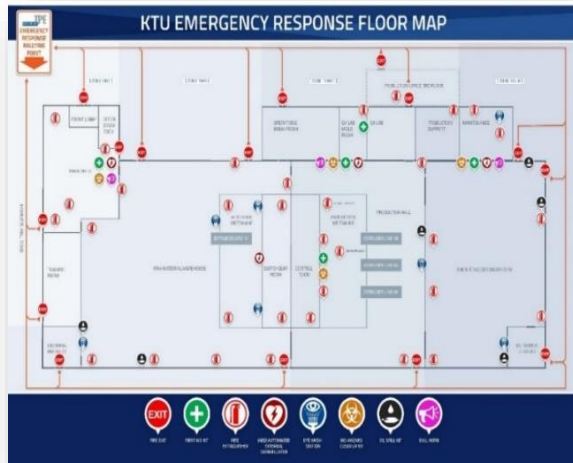

## ENVIRONMENTAL ACCIDENTS / ENVIRONMENTAL ASPECTS



There were no environmental accidents with environmental effects in 2023. Annually we conduct an environmental aspect and impacts analysis which is used to identify KTU's significant environmental aspects. KTU also conducts a Life Cycle Assessment (LCA) to investigate sustainable disposal methods for waste generated from the production of our finished goods.

## SUSTAINABILITY



We have developed a Local Sustainability Board (LSB) to support KTPE's Global Sustainability Initiatives. In 2023 KTAM participated in KTPE's Sustainability workshop led by the Corporate Sustainability team. Purpose of workshop was to develop strategic goals to support KTPE's approved SBTi targets for Scope 1,2, & 3, CO2 emissions reduction and the creation of

KTAM's Materiality Matrix. As an organization we will continue to meet the following objectives:

- Conserve, protect, restore, and improve the supply and quality of natural resources and environmental media (energy, water, materials, ecosystems, land, and air) over the long term.
- Align and integrate programs, tools, incentives, and indicators to achieve as many positive outcomes as possible in environmental, economic, and social systems.
- Consider the full lifecycles of multiple natural resources, processes, and pollutants to prevent pollution, reduce waste, and create a sustainable future.

KTAM completed their 2023 assessment with EcoVadis to evaluate the organization's compliance to the Corporate Social Responsibility management system.

Based on the improvement actions coming from 2022 assessment, the topic of Sustainable Procurement was a key focus in 2023. KTAM with the support from Corporate Purchasing team were able to develop risk assessments and supply chain sustainability documentation which aided in KTAM achieving the "Gold Status" for a 2<sup>nd</sup> consecutive year.



**KRAIBURG TPE CORP**

Buford - United States of America | Manufacture of basic chemicals, fertilizers and nitrogen compounds, plastics and synthetic rubber in  
 EVID: ZP041824



**GREEN ENERGY**



Annually KTU purchases Renewable Energy Certificate (REC) as part of our sustainability efforts. The annual purchase guarantees that an equal amount of renewable energy is delivered to the electric grid and reduction of carbon dioxide emissions.

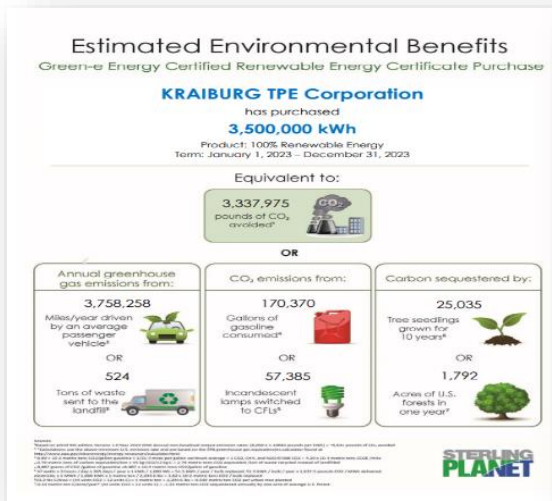

**SPECIFIC ENERGY CONSUMPTION**



Specific energy consumption is measured monthly during energy management meetings utilizing our KBR energy measurement/monitoring system. The KBR

system allows us to quantify the energy efficiency of our production equipment and implement improvement projects where inefficiencies are observed. Implementation of auto-shutoffs for auxiliary production equipment and defined procedures for weekend and extended shutdowns have aided in reducing our overall consumption.

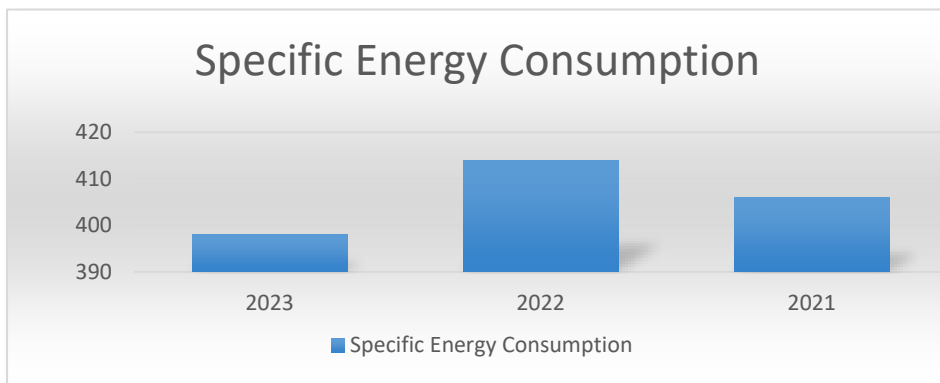

## SPECIFIC WATER CONSUMPTION



Specific water consumption as with our energy, is monitored with the KBR energy measurement/monitoring system. The facility is equipped with low flow water fixtures which aid in our overall consumption.

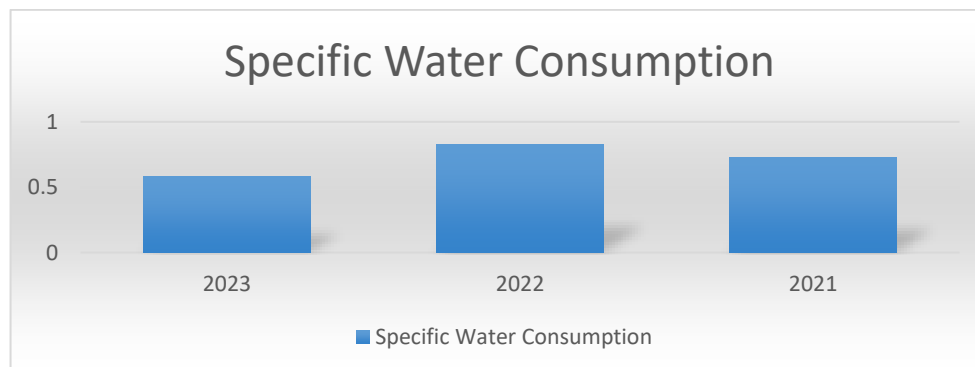



## WASTE MANAGEMENT

The disposal of waste continues to be a key focus for KRAIBURG TPE. The creation of our Waste Management Task Force has been successful in identifying opportunities to partner with local vendors to better manage the waste streams generated within the facility.

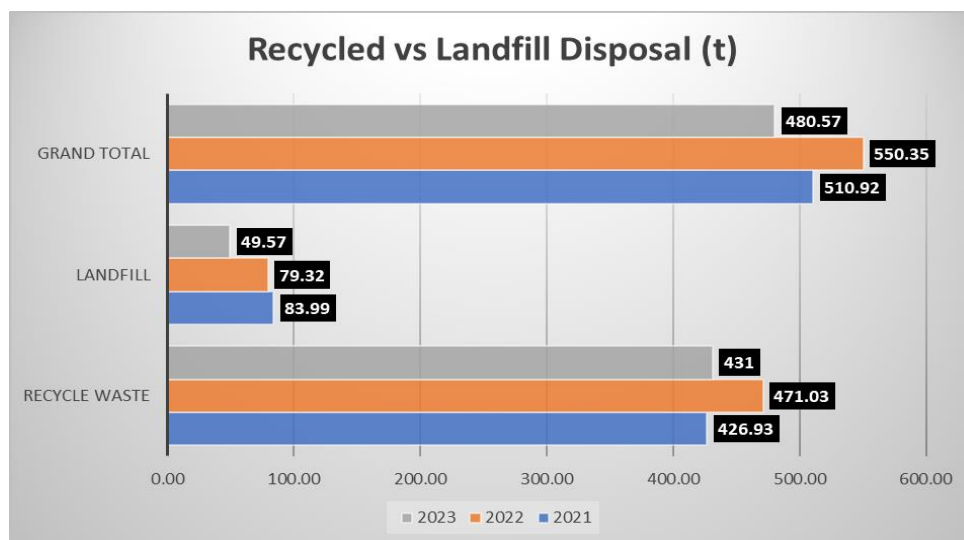

## 2023 INPUT / OUTPUT BALANCE SHEET

The balance sheet is a component of environmental reports and is recommended by ISO 14001. This sheet presents the important factors of the company's activities. The following core indicators are used for the monitoring and control of performances. These key measurables enable a transparent presentation with respect to improvements, and effectiveness.

## 2023 INPUT / OUTPUT BALANCE SHEET FOR KRAIBURG TPE CORP. (USA).

Input	Quantity	Unit	Output	Quantity	Unit
Material consumption production	7140	Mt	Production Quantity	7190	Mt
Electricity	2821	MWh	Waste	480	t
Natural Gas	11,754	thm	Recyclable	431	t
Water	4,126	m <sup>3</sup>	Non-recyclable	49.6	t

## 2023 CORE INDICATORS FOR ENVIRONMENTAL PERFORMANCE AT THE BUFORD LOCATION

Indicators	Definition	Unit of Measure	2023 Target	2023 Act	2022 Act	YoY Trend
Energy efficiency	Electricity / production quantity	kWh/t	<433	398	415	+
Water efficiency	Water / production quantity	m <sup>3</sup> /t	<0.90	0.58	0.83	+
Waste	Waste / production quantity	kg /t	<11.5	6.6	10.2	+
LTIF	Accident-related lost time x 1,000,000 / planned working hours	LTI	<8.5	2.86	8.1	+
Employee Safety Training Percentage	Completed / required safety training	%	>99.0	99.1%	98.3%	+

## 2024 CONTINUOUS IMPROVEMENT

# EH&S

## KTAM ENERGY, EH&S OBJECTIVES & TARGETS 2024

<b>Reduce General Waste Disposal</b>		<ul style="list-style-type: none"> <li>Disposal of general waste at average <math>\leq 11.0\text{kg/mt}</math> for 2024.</li> <li>Develop Waste Management Task for to better define all waste streams within KTU</li> </ul>
<b>Expand Health &amp; Safety</b>		<ul style="list-style-type: none"> <li>Achieve Safety training percentage <math>\geq 99\%</math>.</li> <li>Achieve LTIF (Loss Time Injury Frequency) of <math>\leq 8.5</math></li> <li>Conduct Job Hazard Assessments (JHA) to identify hazards within Operations. Expand First Responder Team</li> </ul>
<b>Achieve Reduction In Energy Consumption For Entire Site</b>		<ul style="list-style-type: none"> <li>Achieve target of <math>\leq 433\text{kWh/mt}</math> for 2024.</li> <li>Utilization of KBR energy monitoring system to identify opportunities to improve efficiency of production equipment.</li> </ul>
<b>Achieve 100% Compliance for EHS obligations</b>		<ul style="list-style-type: none"> <li>Achieve 100% training percentage for Legal Compliance</li> <li>Completion of all monthly, quarterly and annual validations and inspections</li> </ul>

## **SUMMARY**

We at KRAIBURG TPE are engaged in minimizing environmental impacts and improving occupational health and safety. We are also committed to developing local sustainability initiatives to support our corporate strategy. Our policy of creating a safe workplace, conserving resources, reducing environmentally harmful waste and emissions are key to meeting our responsibility to present and future generations.